

# BENSON POLYTECHNIC HS / DAG #10 UPDATE

# AGENDA

## BENSON POLYTECHNIC HS MODERNIZATION UPDATE

- + Schedule & Process Update
- + Summer Work 2020
- + Value Engineering Update
- + Construction Logistics Plan
- + Design Update
  - » Interior Finishes
  - » Exterior Views

## MARSHALL SWING SITE UPDATE

- + Schedule & Process Update
- + CTE Annex Updated Plan

## MULTIPLE PATHWAYS TO GRADUATION BUILDING

- + Schedule & Process Update
- + Design Updates
  - » Site Plan
  - » Parking Approach
  - » Exterior Concept and Views

# BENSON MODERNIZATION / UPDATE

# BPHS MODERNIZATION PROJECT UPDATES

## PROJECT PROGRESS

- + 100% DD set issued on September 1, 2020
- + 50% CD / Building Permit set to be issued February 8, 2021
- + Cost estimates and coordination of 100% DD set ongoing
- + Value Engineering brainstorming and vetting ongoing
- + Historic Landmarks Commission approved project on July 13, 2020
- + Submission to State Historic Preservation Office (SHPO) completed September 1, 2020
- + Demolition permit review in process



# SUMMER WORK UPDATE

- + Blue paint removal at east elevation of main building complete, where new social courtyard will be located
- + Completion of structural tests and other due-diligence
- + Information assisting design team and CMGC for existing conditions understanding and sharpening pencils on risks, contingencies and allowances



# BPHS MODERNIZATION VALUE ENGINEERING IN PROCESS

## SELECTED VALUE ENGINEERING / COST AVOIDANCE STRATEGIES & RECOMMENDATIONS:

- Eliminate unnecessary allowances (Confirm scope complete in documents so lesser or no allowance needed)
- Bike Shelter: Eliminate green roof / provide pre-fabricated structure with solar (Scope within 1.5% solar budget)
- Remove Audio Engineering CTE infrastructure from Auditorium and eliminate alternate
- Remove student access platform at roof for solar panel projects - monitoring will occur via data connection
- Remove second floor stop from elevator at Bldg G1 / Add chair lift at G1 West or relocate elevator
- Bldg A - relocate HVAC unit to roof instead of interior
- Acoustical partitions - meet LEED PreReq only, not additional LEED point.
- Prefabricated wall framing sections
- Clarify intent of plaster "patch, repair, paint" vs. costly "restoration"
- Consider DX cooling at select areas
- Move largest duct collector to ground, reduce quantity of rooftop dust collectors
- Right-size generator to minimum for I/O and PPS Standards (250 in lieu of 450)
- Simplify railing materials in Auditorium

# CONSTRUCTION LOGISTICS PLAN

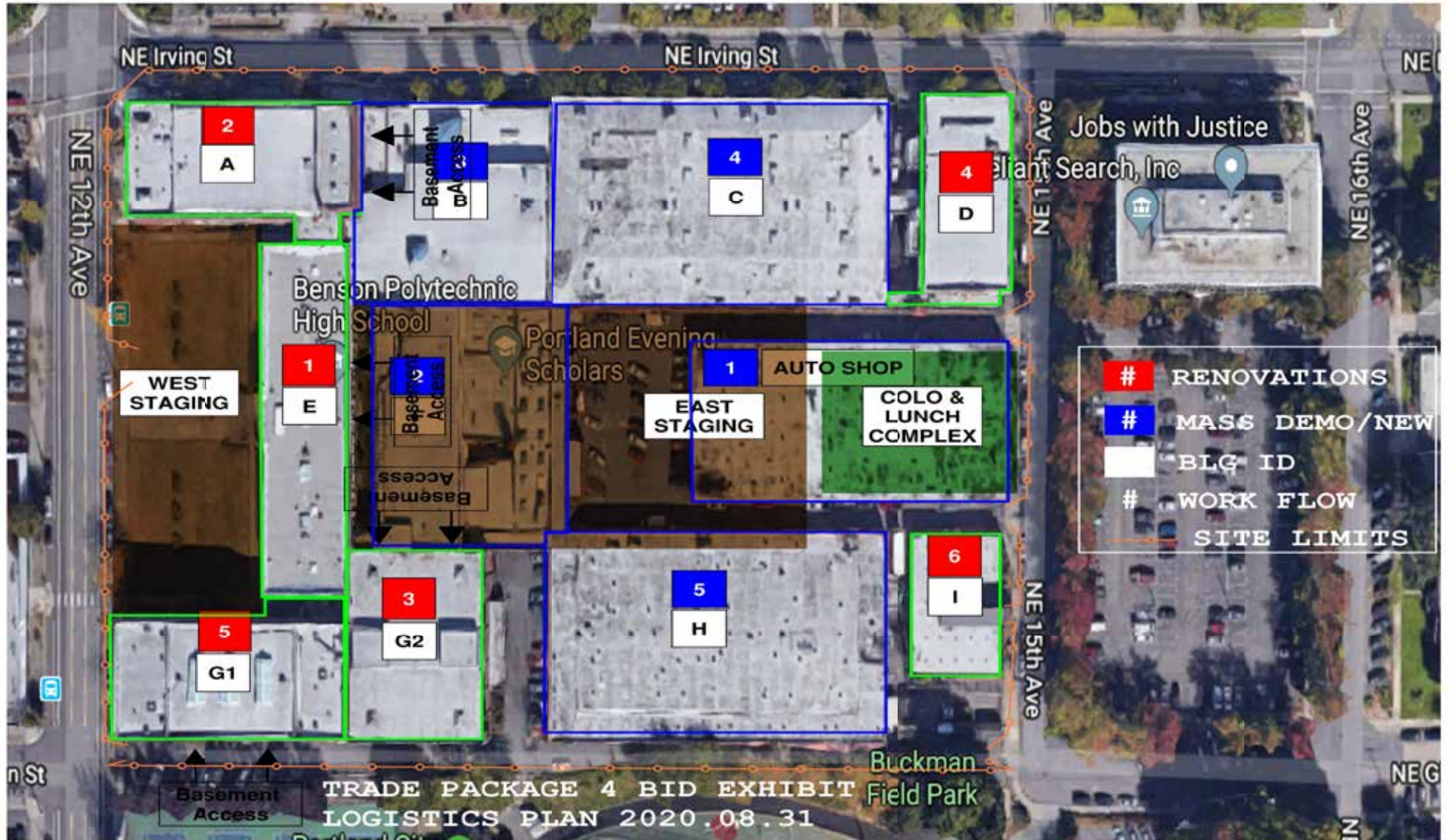

# INTERIOR FINISHES / OVERVIEW



Building E, Administrative Building

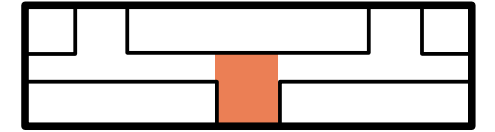

Building E, Administrative Building

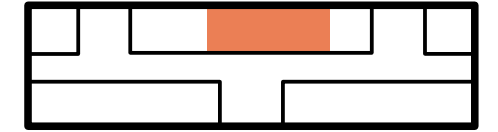

Building A, Auditorium - Alternate

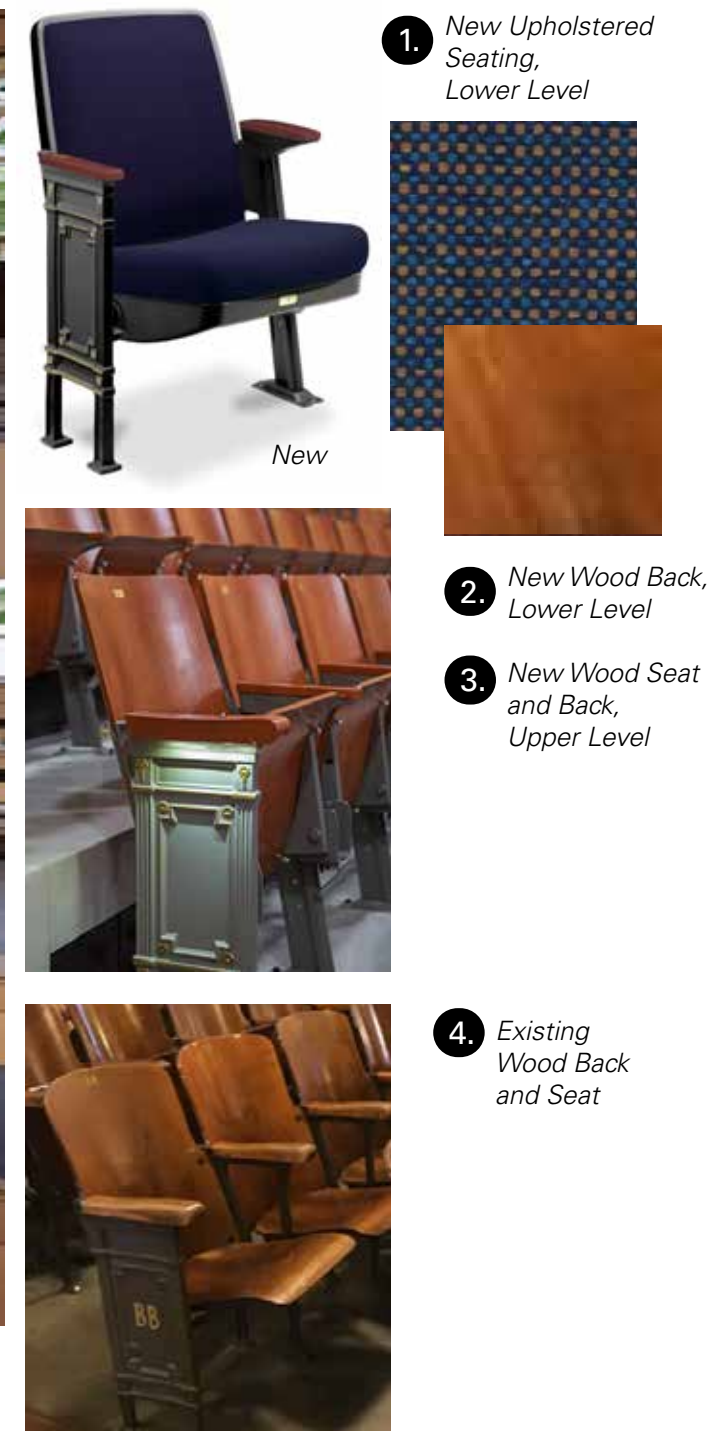
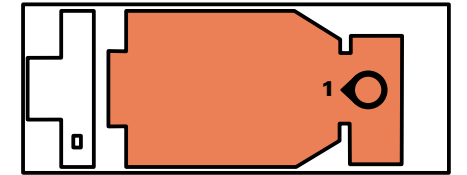

1. Perspective View from Stage towards Auditorium Balcony

Building G1, Historic Gymnasium

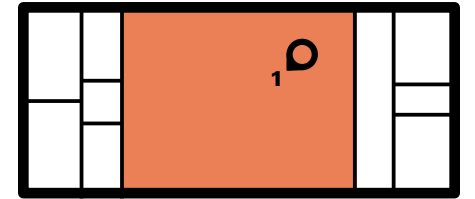







# EXTERIOR VIEWS / OVERVIEW











# MARSHALL SWING SITE / UPDATE

# BENSON SWING SITES PHASING PLAN

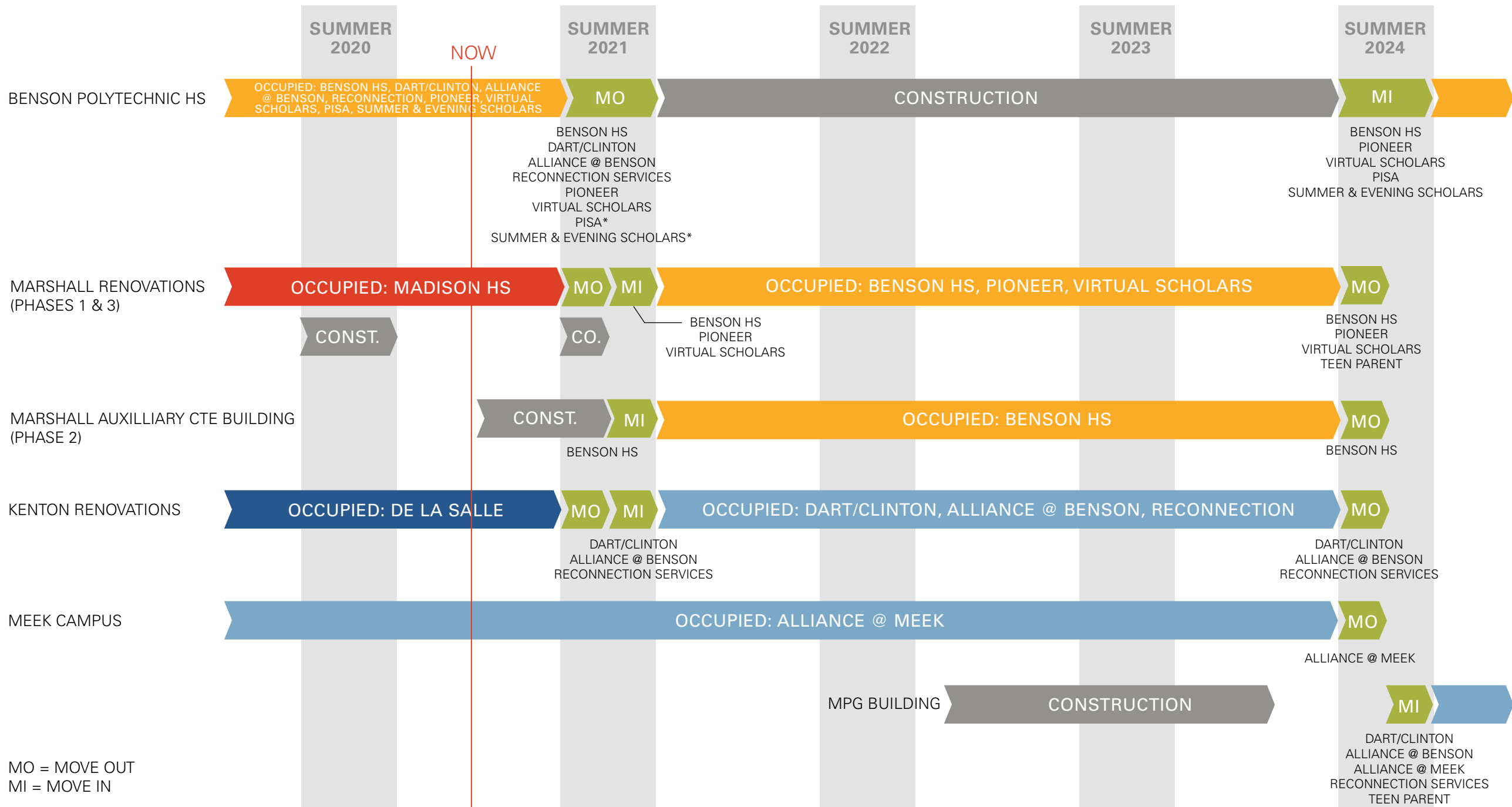

\*SUMMER AND EVENING SCHOLARS TO MOVE TO GRANT HS, AND PISA TO MOVE TO MADISON HS DURING BENSON HS CONSTRUCTION

# MARSHALL SWING SITE PROJECT UPDATES

## PROJECT PROGRESS

- + Summer 2020 infrastructure work complete
- + Team prepping for bidding of CTE Annex Building soon
- + Conditional Use Permit for CTE Annex approved
- + Building Permit review for CTE Annex in process

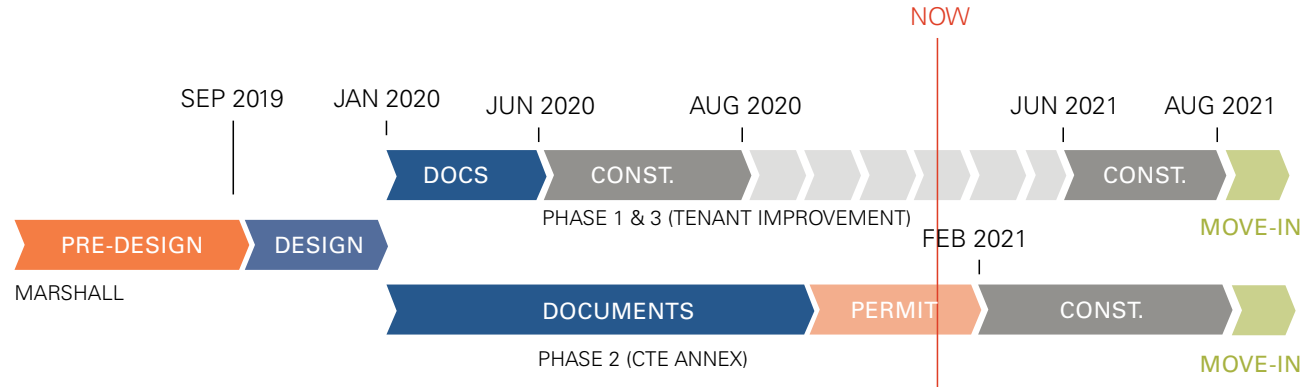

# UPDATED CTE ANNEX FLOOR PLAN

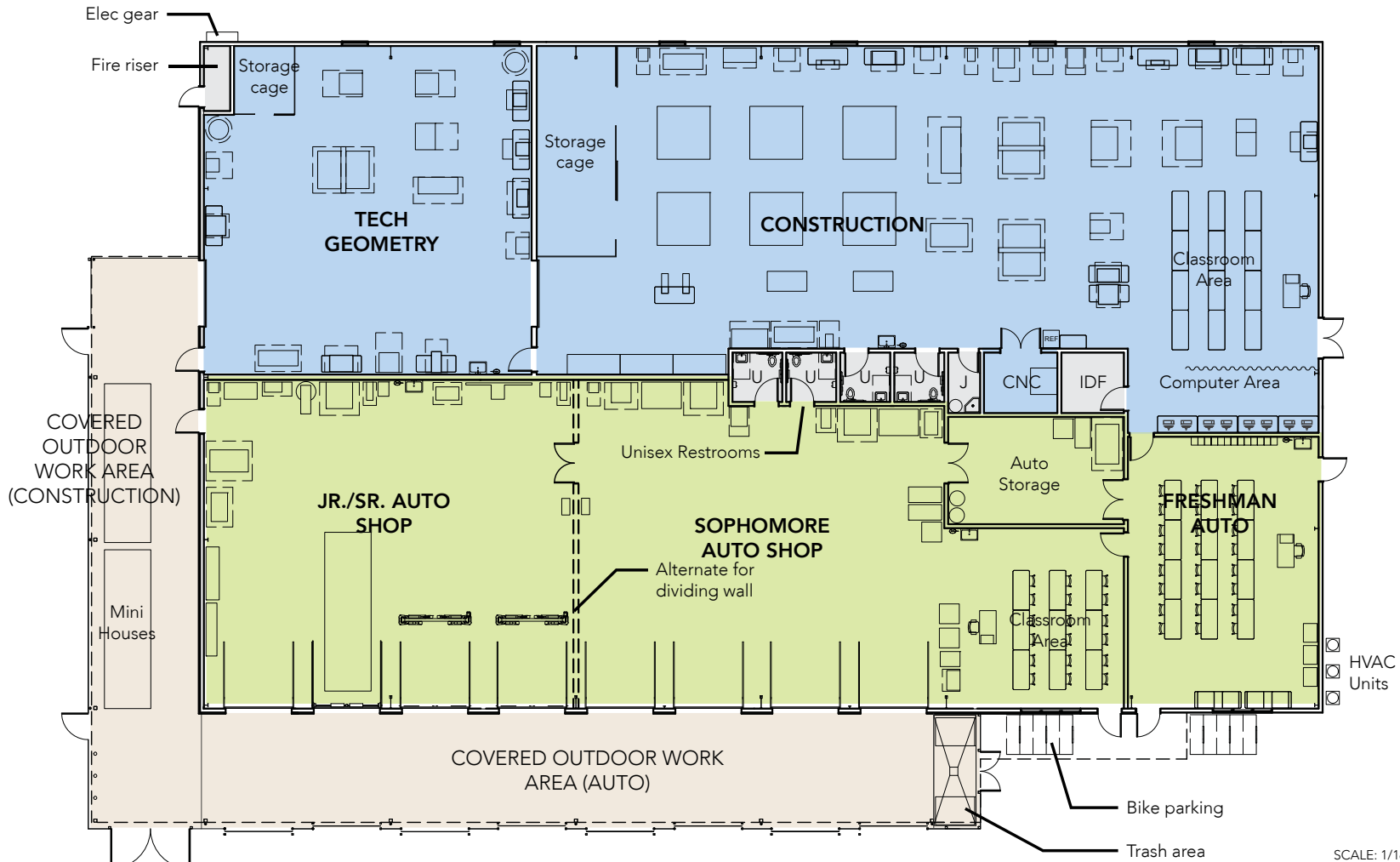

FLOOR PLAN **REVISED OPTION D2**

SCALE: 1/16" = 1'-0"

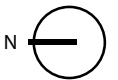



# MULTIPLE PATHWAYS TO GRADUATION / UPDATE

# MPG BUILDING SCHEDULE UPDATE

## DESIGN PROGRESS

- + Schematic Design wrapping up December 21.
- + Coordination with Andersen Construction on mass timber structure approach and pricing of steel alternative
- + Target Value Budget established

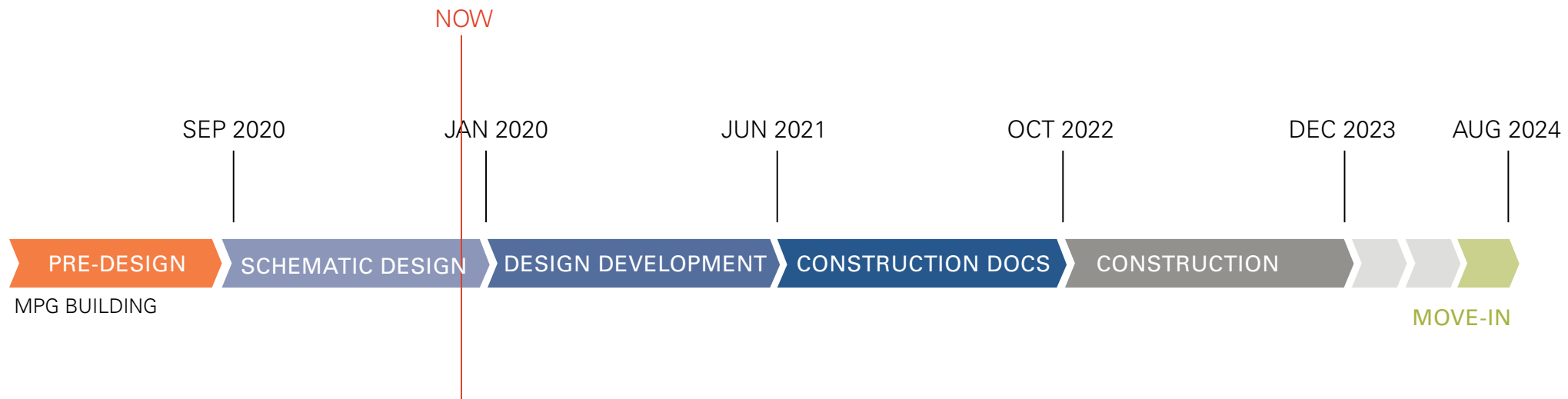

# MPG DESIGN UPDATE

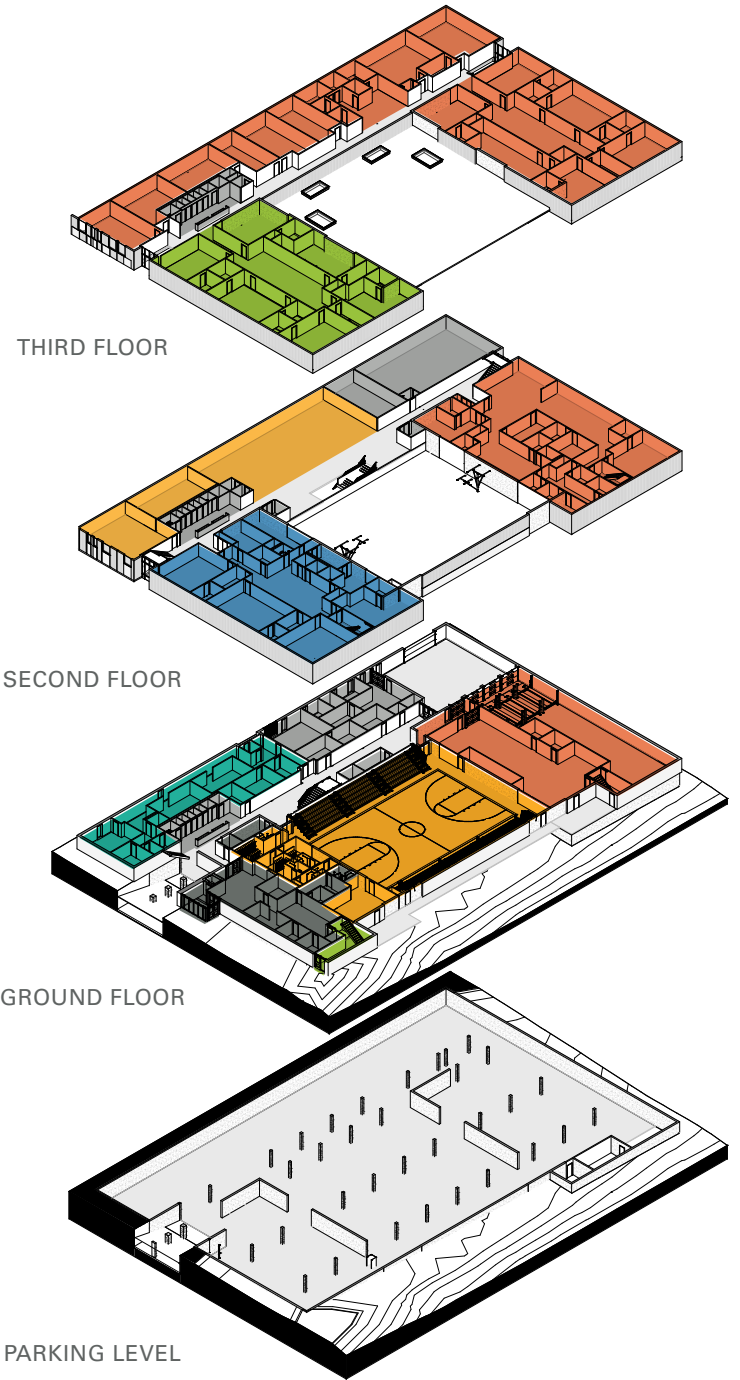
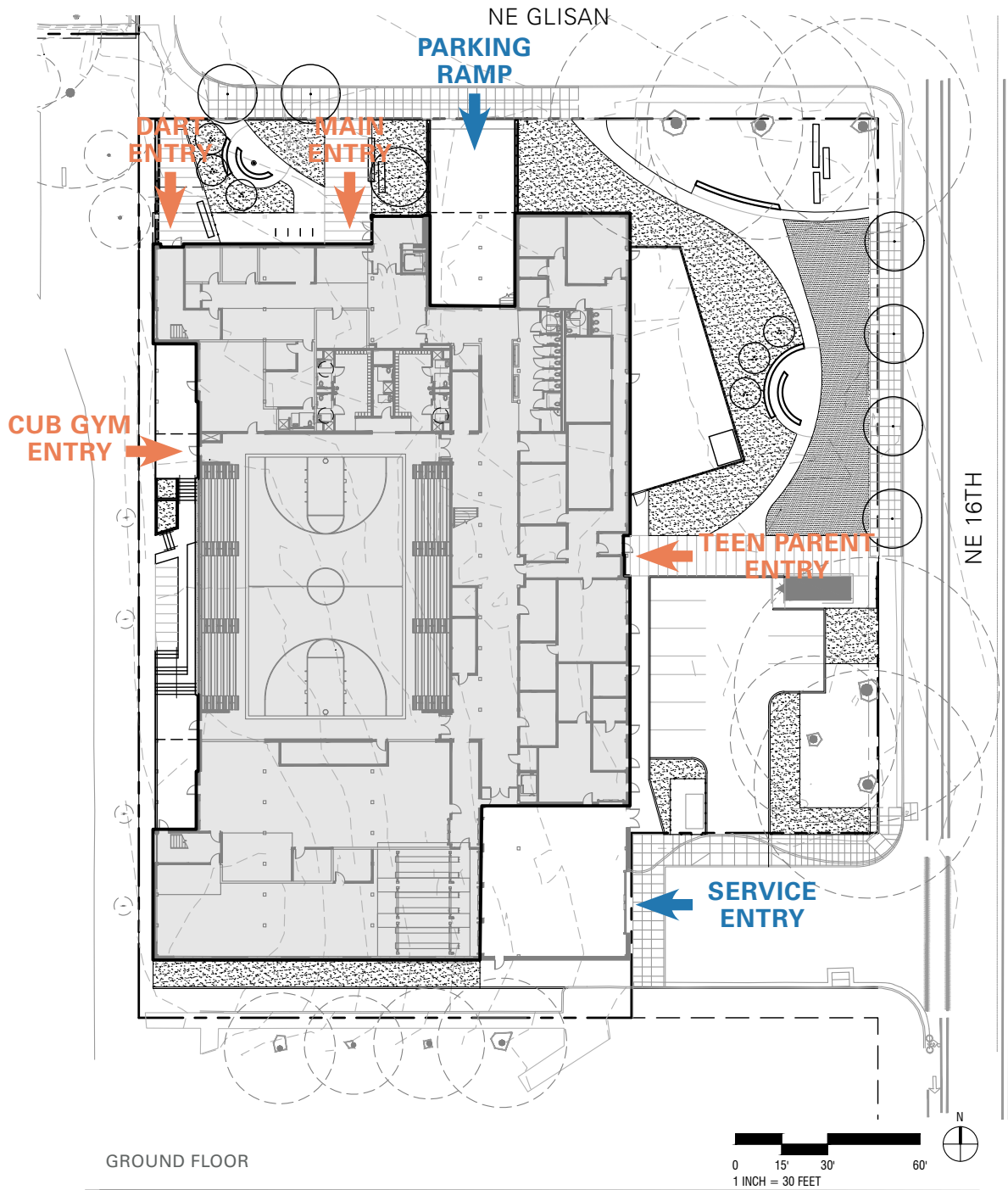

# PARKING USE AND ACCESS

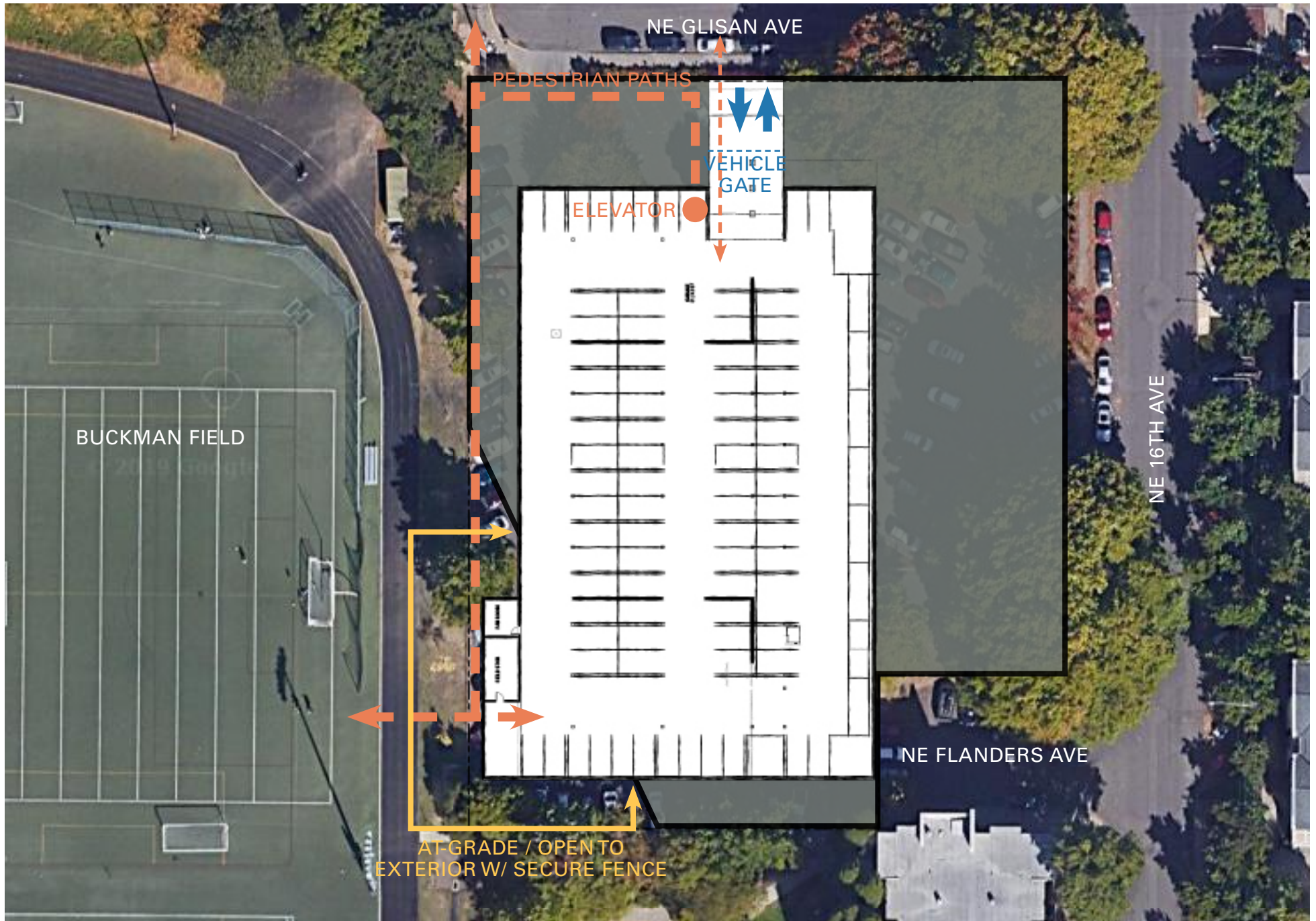

# MPG DESIGN UPDATE

## EXTERIOR DESIGN: TREEHOUSE CONCEPT/THEME



# MPG DESIGN UPDATE

## ACCENT MATERIAL 1 OPTIONS

## ACCENT MATERIAL 2 OPTIONS- SELECTED MATERIAL IN ALTERNATE COLOR



MATERIAL 1 - BRICK

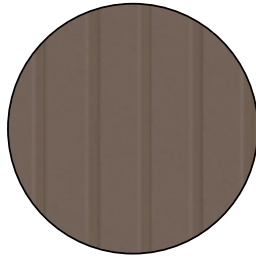

CERAMIC COATED PANEL

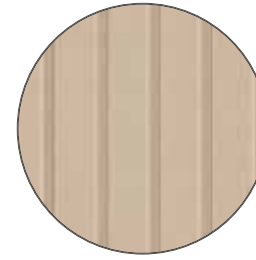

CERAMIC COATED PANEL



MODIFIED WOOD SIDING

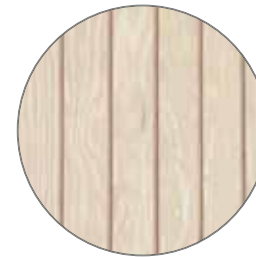

MODIFIED WOOD SIDING

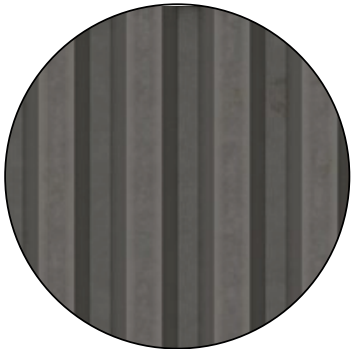

MATERIAL 2 - METAL PANEL

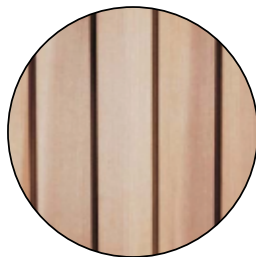

RED CEDAR SIDING

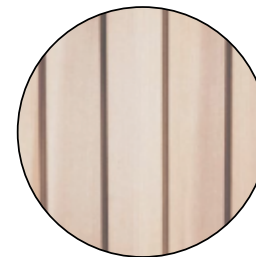

RED CEDAR SIDING

# MPG DESIGN UPDATE



VIEW FROM NE GLISAN TOWARDS FRONT OF BUILDING

# MPG DESIGN UPDATE



VIEW FROM BUCKMAN FIELD TOWARDS SW CORNER OF BUILDING



QUESTIONS OR COMMENTS?

THANK YOU.